

# UROLOGY INSTRUMENTS



# KIDNEY STONE FORCEPS

Nierensteinzangen

Pinces pour les calculs du bassin

Pinzas para cálculoa renales

Pinze per calcoli renali



Randall Kidney Stone Clamps Forceps

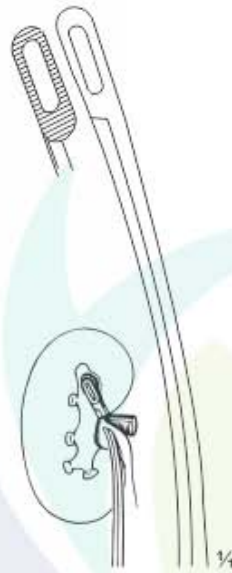

16-001  
23 cm  
quarter curved

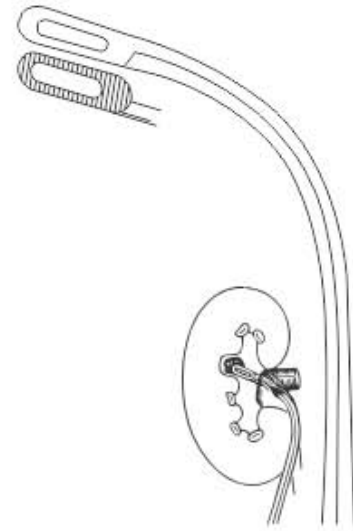

16-002  
23 cm  
half curved

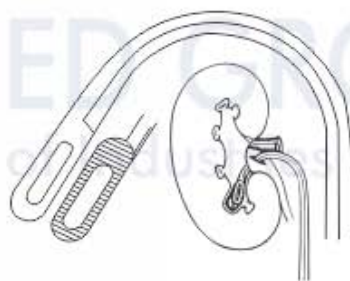

16-003  
23 cm  
full curved

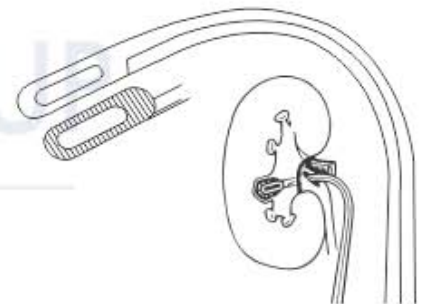

16-004  
23 cm  
three quarter curved

**KIDNEY STONE FORCEPS**

Nierensteinzangen

Pinces pour les calculs du bassin

Pinzas para cálculoa renales

Pinze per calcoli renali



**16-005**  
23 cm



**16-006**  
24.5 cm



**Randall**  
Kidney Stone Forceps



**Heiming**  
Kidney Stone Forceps



**16-007**  
16 cm



**16-008**  
17 cm



**Elsasser**  
Nephrostomy Forceps



**16-009**  
21 cm  
Fig. 1

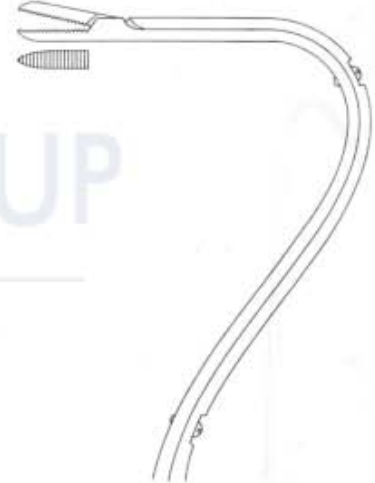

**16-010**  
21 cm  
Fig. 2

ALLIED GROUP  
of Industries

## KIDNEY STONE FORCEPS

Nierensteinzangen | Pincés pour les calculs du bassinét  
 Pinzas para cálculoa renales | Pinze per calcoli renali



**Dartigues Uterine Elevating Forceps**  
 16-011 27 cm



**Collin Kidney Elevating Stone Clamps Forceps**  
 16-012 28.5 cm



**Hulka-Kenwick Uterine Elevating & Manipulating Forceps**  
 16-013 27 cm



**Somer Kidney Elevating Stone Clamps Forceps**  
 16-014 23.5 cm



**Strassmann Kidney Elevating Stone Clamps Forceps**  
 16-015 26 cm



**Collin Kidney Elevating Stone Clamps Forceps**  
 16-016 26.5 cm



**Collin Kidney Elevating Stone Clamps Forceps**  
 16-017 26 cm

## GALL STONE FORCEPS

Gallensteinzangen | Pinces pour calculs biliaires  
Gallensteinlöffel | Curettes pour calculs biliaires



**Blake Gall Stone Forceps**  
16-018 20 cm  
Straight



**Blake Gall Stone Forceps**  
16-019 21 cm  
Curved



**Mayo-Blake Gall Stone Forceps**  
16-020 20 cm  
Straight



**Mayo-Blake Gall Stone Forceps**  
16-021 20 cm  
Curved



**Uro-Tangential Gall Stone Forceps**



**Mixer Gall Stone Forceps**  
16-024 22 cm



**Desjardins Gall Stone Forceps**  
16-025 23 cm



**Desjardins Gall Stone Forceps**  
16-026 23 cm

**CAPSULE FORCEPS, LIGATURE CARRYING FORCEPS**

*Kapselasszangen, Fadenführungszange* | *Pinces pour saisir les capsules, Pince porte-fil*  
*Pinzas capsulares, Pinza porta ligaduras* | *Pinze per afferrare capsule, Pinza porta-filo*



**Harris Capsule Ligature Angled Suture Forceps**



**16-027**  
24 cm



**Johnson Prostatic Needle Holder**



**16-028**  
29 cm



**Stratte Needle Holder**



**16-029**  
23 cm



**Millin Prostatectomy Forceps**  
16-030 24 cm



**Millin Prostatectomy Forceps**  
16-031 23 cm

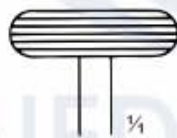

**Millin Vulsellum Forceps**  
16-032 23 cm



**Millin Ligature Carrying Forceps Angular**  
16-033 23 cm

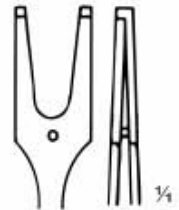

## PROSTATIC RETRACTOR

Prostatahaken

Ecarteurs prostatiques

Separadores para próstata

Divaricatori prostatici

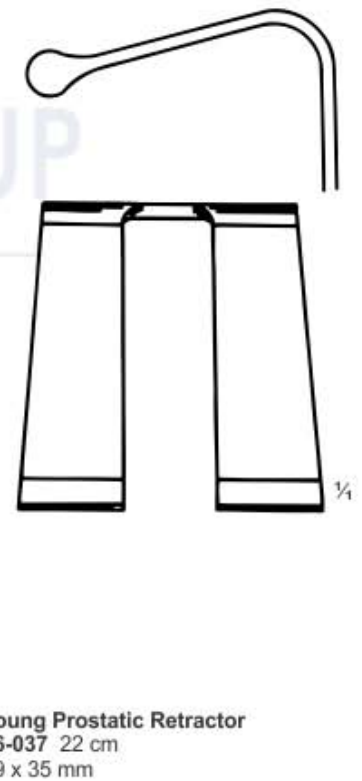
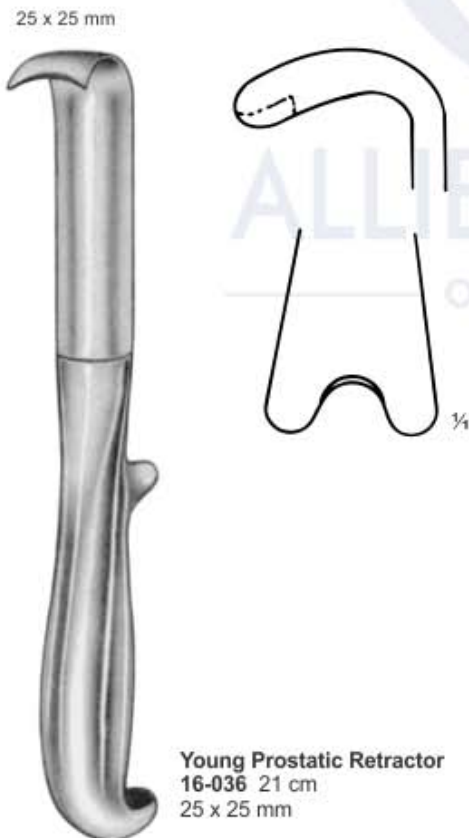
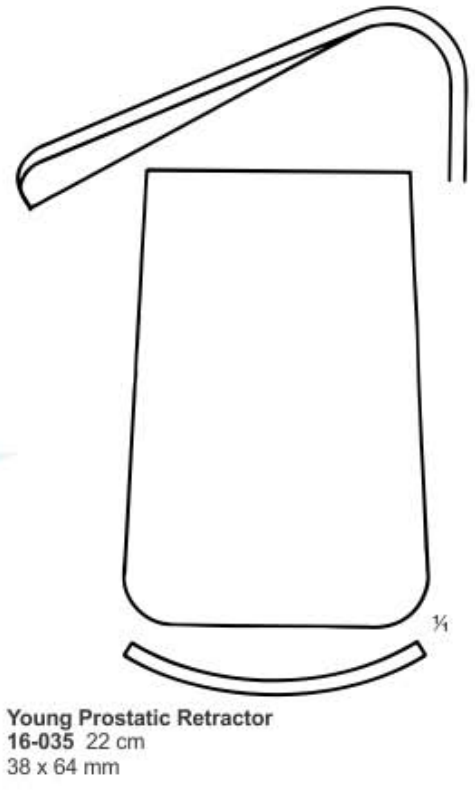
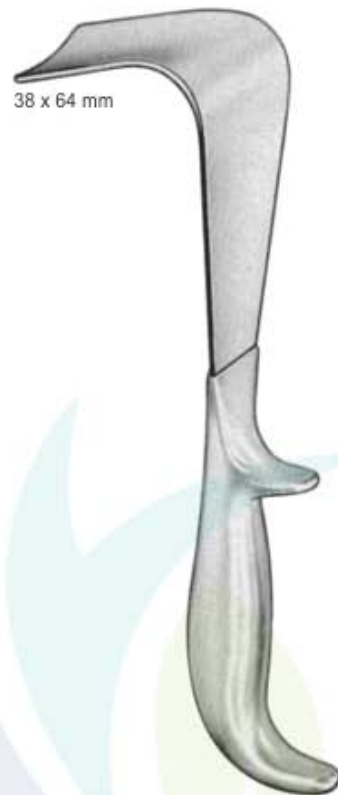
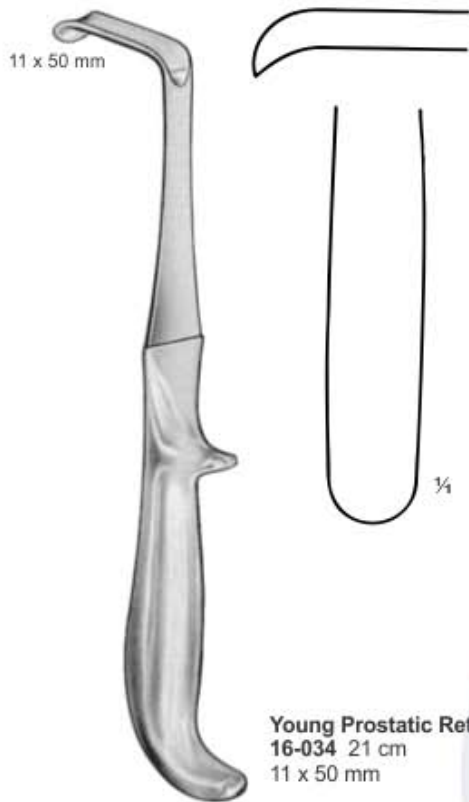

# GALL DUCT DILATOR

Gallenkanaldilatatoren | Dilatateurs pour les voies biliaires  
 Gallensteinzangen | Pincettes pour calculs biliaires

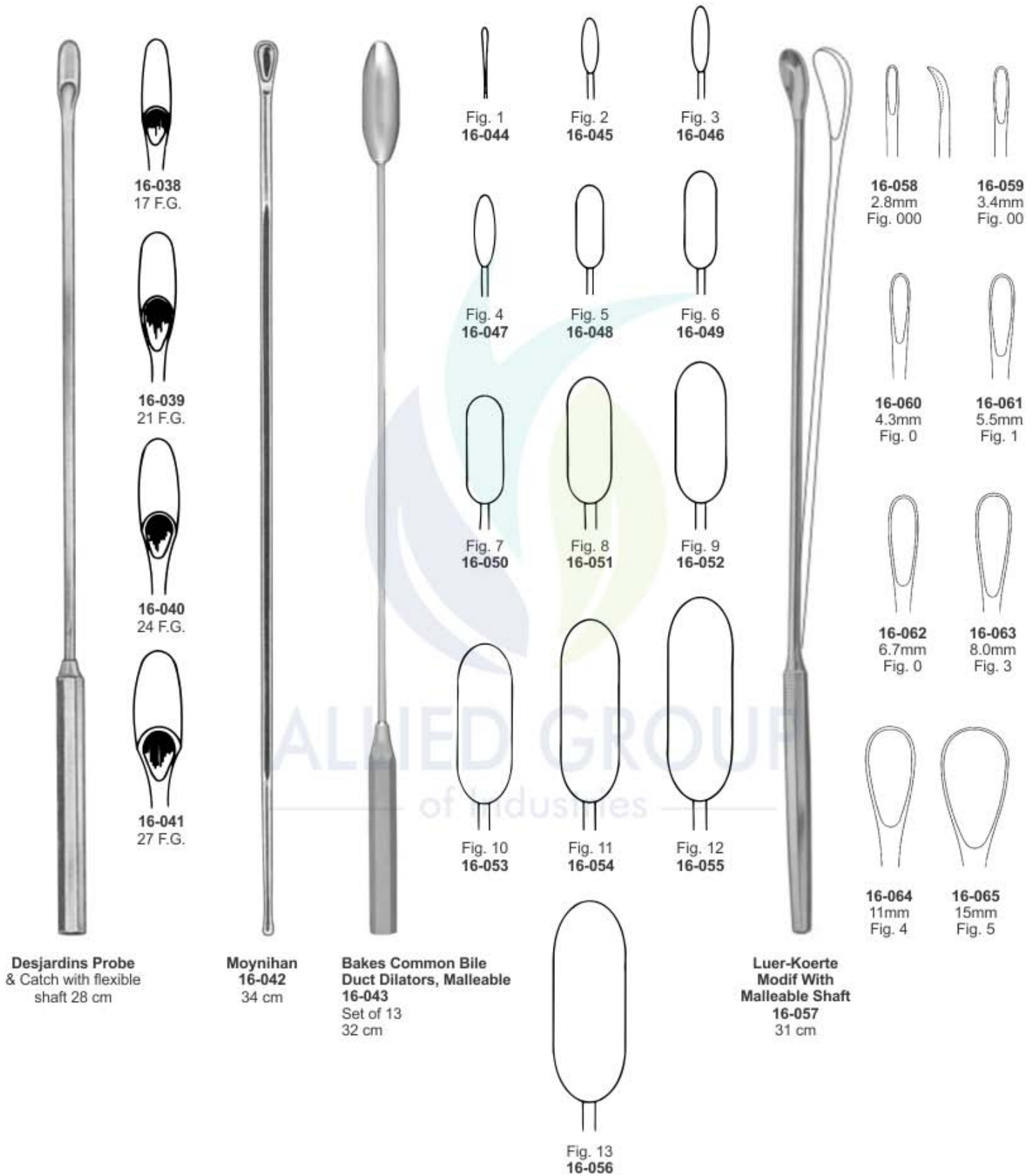



## URETHRAL CATHETERS

Urethral catheter | Cateteri Uretrali  
Sondes Urétrales | Catéteres Uretrales



**Catheter**  
**16-066**  
15 cm  
No. 6-16



**Catheters 29 cm**  
Male Catheters charr., Metal

French  
16-067 8  
16-068 10  
16-069 12  
16-070 14  
16-071 16  
16-072 18  
16-073 20



**Lister Bougies**  
**16-074**  
27 cm  
00 / 1 to 15 / 18  
set of 17



**Clutton Bougies**  
**16-075** 27 cm  
06 / 10 FG to 28 / 32  
set of 12



**Van Buren**  
**Urethral Sound**  
**16-076**  
A to O  
Set of 15

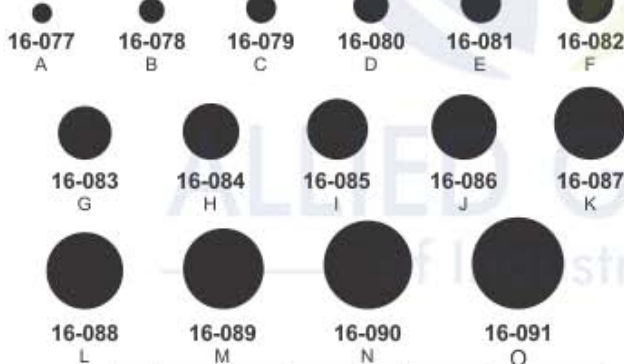
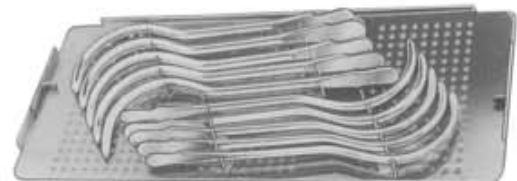

Fig.	Item	Description	Inches	Dia. Charr
A	16-077	28 cm	11"	8 French
B	16-078	28 cm	11"	10 French
C	16-079	28 cm	11"	12 French
D	16-080	28 cm	11"	14 French
E	16-081	28 cm	11"	16 French
F	16-082	28 cm	11"	18 French
G	16-083	28 cm	11"	20 French
H	16-084	28 cm	11"	22 French
I	16-085	28 cm	11"	24 French
J	16-086	28 cm	11"	26 French
K	16-087	28 cm	11"	28 French
L	16-088	28 cm	11"	30 French
M	16-089	28 cm	11"	32 French
N	16-090	28 cm	11"	34 French
O	16-091	28 cm	11"	36 French



**Guyon**  
**16-092**  
420 x 175 x 40 mm  
Set in metal case containing:  
— 21 Bougies Guyon  
— 6 filiform Bougies

# URETHRAL CATHETERS

Urethalkatheter | Cateteri Uretrali  
Sondes Urétrales | Catéteres Uretrales



**Dittel**  
22.5 cm  
urethral bougies and  
dilating sounds

Charr. (French)	
16-093	8
16-094	9
16-095	10
16-096	11
16-097	12
16-098	13
16-099	14
16-100	15
16-101	16
16-102	17
16-103	18
16-104	19
16-105	20
16-106	21
16-107	22
16-108	23
16-109	24
16-110	25
16-111	26
16-112	27
16-113	28
16-114	29
16-115	30



**Dittel**  
35 cm  
urethral bougies and  
dilating sounds

Charr. (French)	
16-116	8
16-117	9
16-118	10
16-119	11
16-120	12
16-121	13
16-122	14
16-123	15
16-124	16
16-125	17
16-126	18
16-127	19
16-128	20
16-129	21
16-130	22
16-131	23
16-132	24
16-133	25
16-134	26
16-135	27
16-136	28
16-137	29
16-138	30



33 cm  
filiform guides,  
olive tip

Charr. (French)	
16-139	3
16-140	4
16-141	5
16-142	6



**Guyon**  
16-143  
25 cm  
Set  
urethral bougies and  
dilating sounds  
without filiform guides,  
with thread in tip

Charr. (French)	
16-144	Ben. 24 / Charr. 12 Ben. 25
16-145	Ben. 26 / Charr. 13 Ben. 27
16-146	Ben. 28 / Charr. 14 Ben. 29
16-147	Ben. 30 / Charr. 15 Ben. 31
16-148	Ben. 32 / Charr. 16 Ben. 33
16-149	Ben. 34 / Charr. 17 Ben. 35
16-150	Ben. 36 / Charr. 18 Ben. 37
16-151	Ben. 38 / Charr. 19 Ben. 39
16-152	Ben. 40 / Charr. 20 Ben. 41
16-153	Ben. 42 / Charr. 21 Ben. 43
16-154	Ben. 44 / Charr. 22 Ben. 45
16-155	Ben. 46 / Charr. 23 Ben. 47
16-156	Ben. 48 / Charr. 24 Ben. 49
16-157	Ben. 50 / Charr. 25 Ben. 51
16-158	Ben. 52 / Charr. 26 Ben. 53
16-159	Ben. 54 / Charr. 27 Ben. 55
16-160	Ben. 56 / Charr. 28 Ben. 57
16-161	Ben. 58 / Charr. 29 Ben. 59
16-162	Ben. 60 / Charr. 30

*Blasenhalsperrer, Blasenwundsperrer*

*Ecarteur pour le col de la vessie, Ecarteurs vésicaux*

*Dilatador para el cuello vesical, Separadores vesicales*

*Divaricatore del collo vescicale, Divaricatore vescicale*



**Knutson**  
16-163 18 cm  
Urethrographie-Instruments



**Mogen Circumcision Clamp**  
16-165



**Circumcision Shield**  
16-166 10cm



**Winkelmann Circumcision Clamps**  
16-167 12 mm Ø  
16-168 16 mm Ø  
16-169 20 mm Ø

ALLIED GROUP  
of Industries

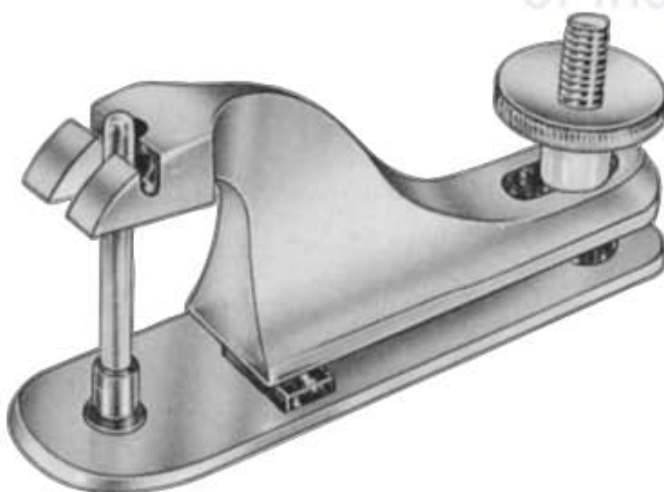

**Gumco Circumcision Clamp**  
mm Ø  
16-170 8  
16-171 11  
16-172 13  
16-173 16  
16-174 21  
16-175 26  
16-176 32



**Stockmann Penile Clamp**  
16-177 8cm

## BLADDER NECK SPREADER, BLADDER RETRACTORS

Blasenhalsperrer, Blasenwundsperrer

Ecarteur pour le col de la vessie, Ecarteurs vésicaux

Dilatador para el cuello vesical, Separadores vesicales

Divaricatore del collo vescicale, Divaricatore vescicale



**Millin Bladder Neck Spreader**  
16-178  
28 cm



**Zieser Meaeus Clamp**  
16-179 10cm

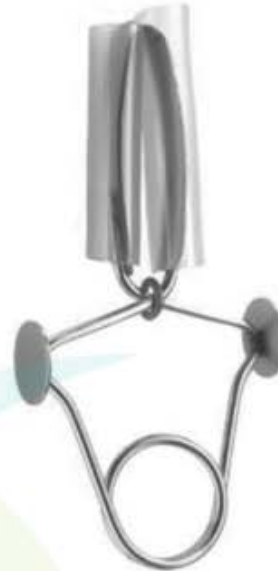

**Strauss Penile Clamp**  
16-180 11cm



**Thomson Walker Penile Clamp**  
16-181



**Lewkowitz Lithotomy Forceps**  
16-182 26cm Str.



**Lewkowitz Lithotomy Forceps**  
16-183 26cm Cvd



**Young Lobe Holding Forceps**  
16-184 20cm

Blasenhalsperrer, Blasenwundsperrer

Ecarteur pour le col de la vessie, Ecarteurs vésicaux

Dilatador para el cuello vesical, Separadores vesicales

Divaricatore del collo vescicale, Divaricatore vescicale



**Legueu Bladder Spatula**  
16-185

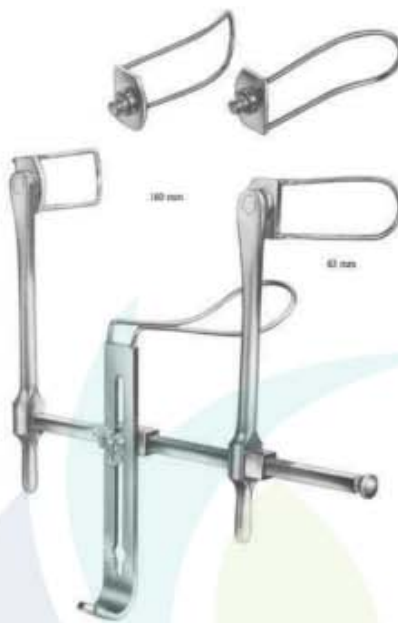

**Gosset Bladder Retractor**  
16-186 160mm



**Thomson Walker Bladder Retractor**  
16-187



**Pantings Bladder Retractor**  
16-188



**Judd Masson Bladder Retractor**  
16-189  
w/center blade



**Millin Bladder Retractor**  
16-190

Leistenbruch Director, Vasektomie Zange, Schraubstock & Blase Retractor  
 Directora Hernia, Pinzas vasectomia, abrazadera y la vejiga retractor

Directeur de hernie, Pinces de vasectomie, Clamp et la vessie enrouleur  
 Direttore Ernia, Pinze vasectomia, Clamp & vescica Divaricatore



**Child Hernia Director**  
16-191



**Key Hernia Director**  
16-192



**Teale Hernia Director**  
16-193



**Millin Suction Tube**  
16-194



**Cord Hook**  
16-195  
blunt 16cm



**Gutmann Secretions Scoop**  
16-196 26cm



**No Scalpel Vasectomy Ringed Forceps Clamps**  
16-197 14cm



**No Scalpel Vasectomy Hemostat Forceps**  
16-198 14cm  
smooth sharp point curved



**Legueu Bladder Retractor**  
16-199  
27cm



**Kocher's Bladder Retractor**  
16-200 23.5 cm

**RECTUM VASECTOMY SET OF 4 PCS  
16-201**



**RECTUM VASECTOMY SET OF 4 PCS  
16-202**



**RECTUM VASECTOMY SET OF 2 PCS  
16-203**



**RECTUM VASECTOMY SET OF 3 PCS  
16-204**



**RECTUM VASECTOMY SET OF 4 PCS  
16-205**